

GUILDHALL

SALES & LETTINGS



13 Manor Avenue

Fulwood, Preston, PR2 8DN

£280,000



A fantastic opportunity to acquire a spacious and well-presented four-bedroom semi-detached home, ideally located in the highly sought-after residential area of Fulwood. Within close proximity to highly regarded schools, Royal Preston Hospital, local amenities, and excellent transport links, this property is not to be missed!

Set on a desirable tree-lined avenue, this generous property offers ample living space throughout and is perfect for growing families or those looking to upsize.

On the ground floor, the accommodation comprises two bright and airy reception rooms, a practical utility room, a convenient downstairs WC, and a well-proportioned kitchen with access to the rear garden. Upstairs, the property boasts four good-sized bedrooms, a family bathroom, and a separate WC – ideal for busy households.

Externally, there is a private rear garden with access to a shed and potential for further extension (subject to planning permission).

Viewings are essential, for further information or to arrange a viewing, please call the team on 01772 769999.



Ground Floor

Hallway

Under Stairs Storage / Cloak Room

Reception Room One 14'0" x 11'8" (4.29m x 3.58m)

Reception Room Two 11'8" x 10'8" (3.57m x 3.26m)

Kitchen 10'2" x 9'4" (3.11m x 2.85m)

Utility 10'2" x 5'10" (3.11m x 1.80m)

WC 4'6" x 2'3" (1.39m x 0.70m)

Storage

First Floor

Bedroom One 13'8" x 11'10" (4.18m x 3.62m)

Bedroom Two 11'8" x 11'6" (3.57m x 3.51m)

Bedroom Three 9'4" x 6'6" (2.86m x 2.0m)

Bedroom Four 7'2" x 5'11" (2.19m x 1.82m)

Bathroom 6'5" x 4'1" (1.97m x 1.27m)

WC 4'1" x 2'1" (1.25m x 0.65m)

Shed 4' x 8' (1.22m x 2.44m)

Area Map



Floor Plans

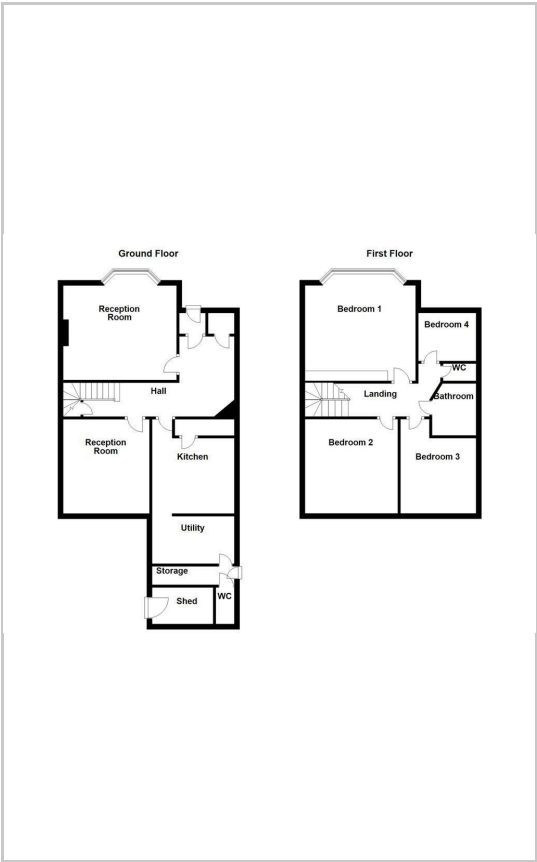

Energy Efficiency Graph

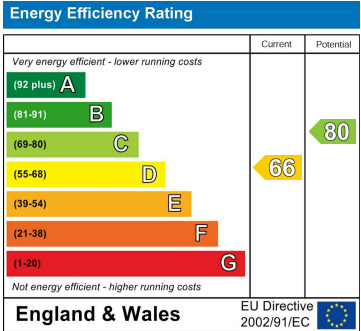

These particulars, whilst believed to be accurate are set out as a general outline only for guidance and do not constitute any part of an offer or contract. Intending purchasers should not rely on them as statements of representation of fact, but must satisfy themselves by inspection or otherwise as to their accuracy. No person in this firms employment has the authority to make or give any representation or warranty in respect of the property.